

CHARMILL

RESIDENTIAL



Chippenham Road, Maida Vale W9

£657



Chippenham Road



Description

HMO FRIENDLY A recently refurbished three bedroom, two bathroom second floor apartment set in a period property in the heart of Maida Vale. The property comprises an open plan kitchen/reception room with wooden flooring, three double bedrooms and two bathrooms. Located moments away from local amenities and within easy reach to Warwick Avenue (Bakerloo line) and Maida Vale stations (Bakerloo line).

- Three bedrooms
- Second floor apartment
- Open plan kitchen/reception
- Well-located
- Two bathrooms
- Recently refurbished
- Wooden flooring
- HMO FRIENDLY





Floor Plan

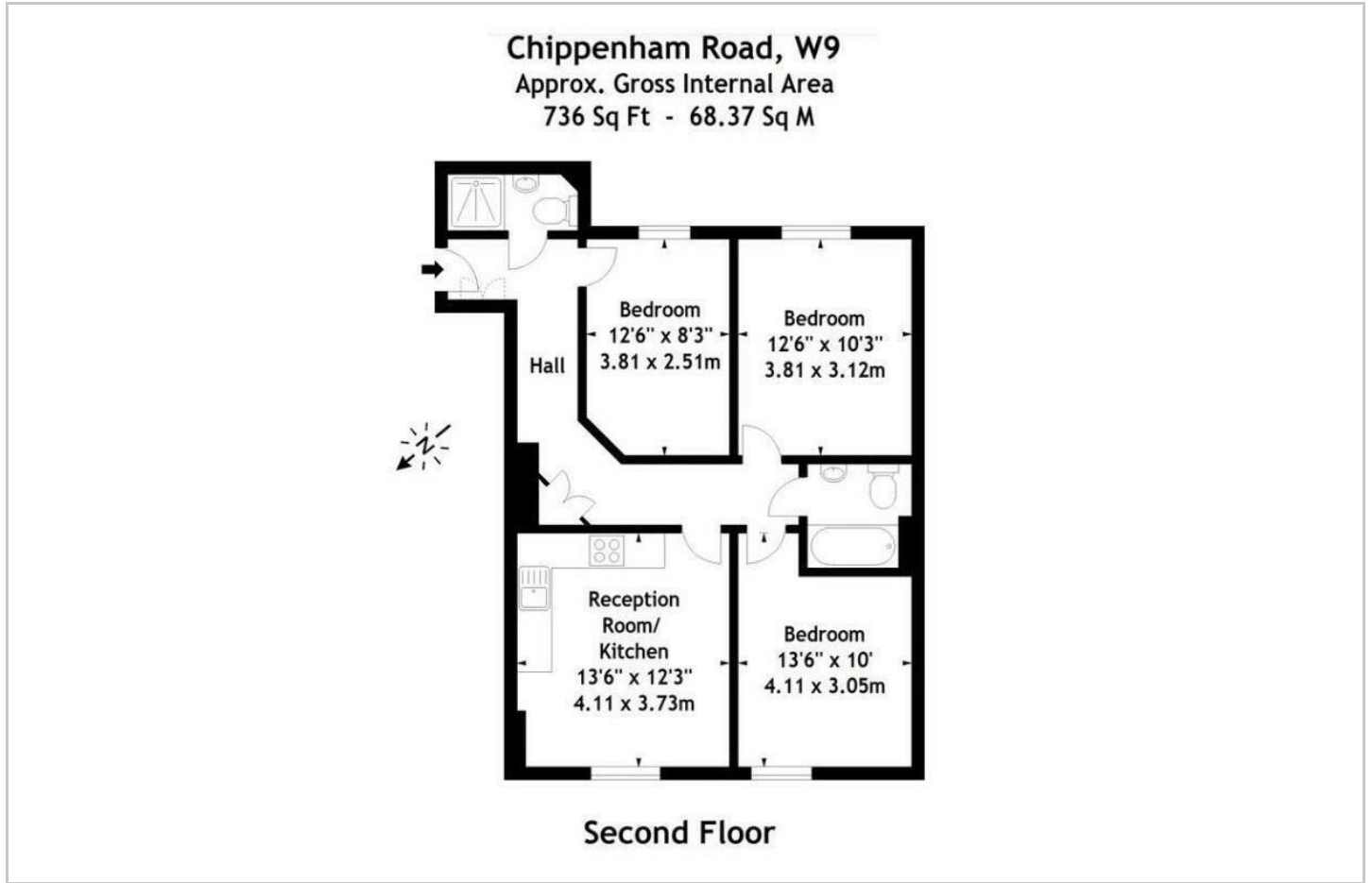

Area Map

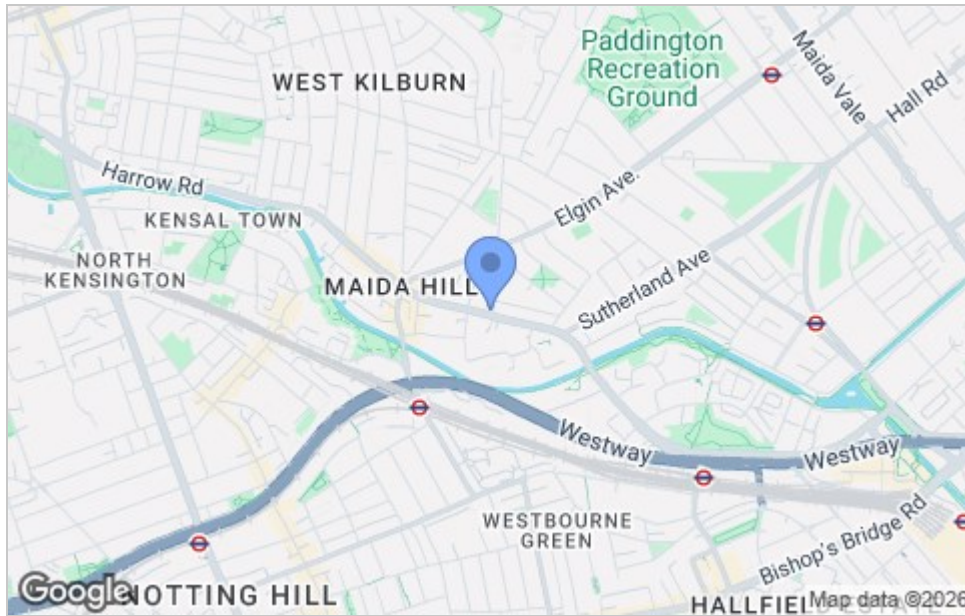

Viewing

Please contact us on 020 7046 6275 if you wish to arrange a viewing appointment for this property or require further information.

Energy Efficiency Graph

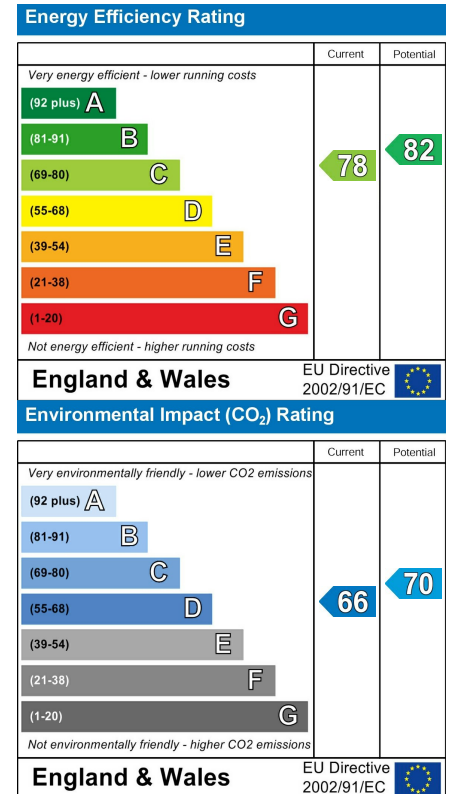

These particulars, whilst believed to be accurate are set out as a general outline only for guidance and do not constitute any part of an offer or contract. Intending purchasers should not rely on them as statements of representation of fact, but must satisfy themselves by inspection or otherwise as to their accuracy. No person in this firm's employment has the authority to make or give any representation or warranty in respect of the property.

020 7046 6275 • sales@chamillresidential.co.uk • 51 Maida Vale, Little Venice, London W9 1SD
 charmillresidential.co.uk